

General

Productgroup PowerSocket Fuse
Mounting type Massive Pressfit Techn
Material Bronze
Surface tin
Customs tariff number 85366930
Country of origin Federal Republic of Germany
Weight per piecs ~ 0.008900 kg

Technical data

Terminal blind hole
Socket length x Socket width 36.20 mm x 7.20 mm
Socket height 17.00 mm
Height total 22.00 mm
Height over pcb 17.00 mm
No. of Pins 20
Pin length 5.00 mm
Grid dimension X / Y 2.54 mm / 3.18 mm
Pin alignment Two row

Processing

Press in force 800 N up to 5000 N
Retention force 60-80 % of press-in force
Press-in speed 100 mm/min. up to 250 mm/min.
PCB thickness 1.60 mm up to 3.20 mm
Notice

Current carrying capacity

Part (20°C) ~ / (85°C) ~ Depending on component to be contacted

Usage and storage

Temperature -40°C up to +150°C
Storage dry environment protected from weather conditions
Storage conditions at +5°C up to +40°C, 75% RH, non-condensing

Accessories

Press in tool

Co-applicable documents

Powerelement Guidelines [Link to Powerelement Guidelines](#)

Standard drill pattern

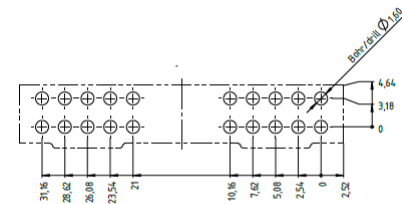

Drill hole specification for PCB

Drill Ø		drill tool	1,60 mm
		drill hole	1,60 mm - 0,025 mm
Cu		Cu - in Hole	Average 30 µm - 60 µm min. 25 µm, max. 80 µm *
End Ø		HAL	(1,450 mm +/- 0,05 mm)
		chem. surfaces	(1,475 mm +/- 0,05 mm)

Note: For Press-fit Technology drill diameter and copper thickness are fix. End Ø for reference only.

* single measurement points in microsection

Dimensions

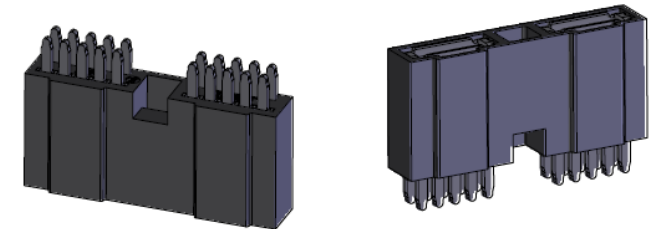
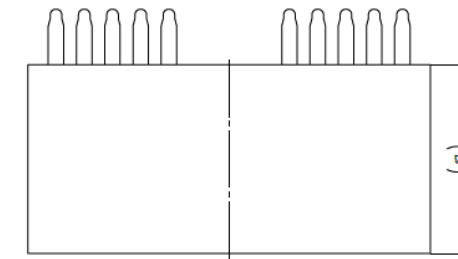
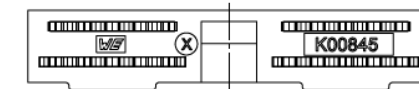
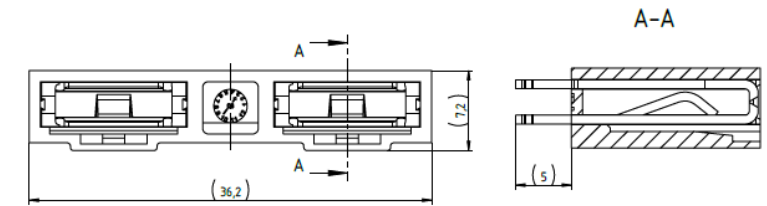

Würth Elektronik ICS GmbH & Co. KG
Würthstraße 1 74676 Niedernhall, Germany
P +49 7940 9810-4444 powerelement@we-online.de
www.powerelement.com

Observe protective note ISO 16016. Passing on or duplication without previous written agreement forbidden. Violations oblige to compensation. All rights reserved in the event of a patent or utility model protection. Subject to change without notice! Is NOT subject to change service!

General tolerances
DIN ISO 2768-mH

Projection mode



Revision	Date	All measures in
F	03.12.25	mm

Part no.

S92726

Description

PowerSocket Fuse MAXI®



REACH
COMPLIANT



RoHS
COMPLIANT